



STAINLESS STEEL

150 LBS SCREWED FITTINGS

BSPP (ISO 228-1), BSPT (ISO 7-1), NPT THREAD

DIMENSION CONFORM TO ASME B16.3 AND ANSI/MSS SP-114-2018 WHERE APPLICABLE

MATERIAL CONFORM TO ASTM A351 GR. CF8 & CF8M

PRESSURE-TEMPERATURE RATINGS 300 PSI (-29 TO 66°C)

MADE BY LOST WAX INVESTMENT CASTING

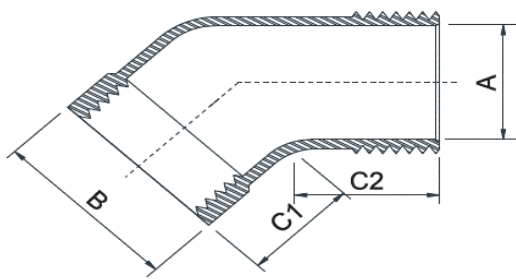

ELBOW 45° M.F.

SIZE	A	B	C1	C2	Weight
	(mm)	(mm)	(mm)	(mm)	(Kg/Pc)
1/8"	4.0	13.0	15.0	15.5	0.02
1/4"	6.4	16.0	16.0	16.5	0.03
3/8"	9.0	19.0	18.0	18.5	0.04
1/2"	13.0	26.5	18.5	20.0	0.07
3/4"	18.0	32.3	23.5	22.5	0.11
1"	24.0	40.0	27.0	26.5	0.18
1 1/4"	30.5	49.3	31.0	28.0	0.25
1 1/2"	35.8	56.0	34.0	27.0	0.35
2"	46.4	68.3	37.5	31.0	0.50
2 1/2"	66.0	90.0	48.0	43.0	0.88
3"	77.0	100.0	52.0	46.0	1.16
4"	103.0	127.0	55.0	52.0	1.94